

# Every Power.



## QSB3.3

### QSB3.3 Ratings

ENGINE MODEL	ADVERTISED HORSEPOWER	PEAK TORQUE	ASPIRATION
QSB3.3*	110HP @ 2400 RPM	306 LB-FT @1600 RPM	Turbocharged/Charge Air Cooled
QSB3.3	99HP @ 2600 RPM	306 LB-FT @1600 RPM	Turbocharged/Charge Air Cooled
QSB3.3	85HP @ 2600 RPM	274 LB-FT @1400 RPM	Turbocharged/Charge Air Cooled

\*RESTRICTED RATINGS  
ADDITIONAL RATINGS ARE AVAILABLE. CHECK WITH YOUR CUMMINS DISTRIBUTOR  
**Emission Certification: U.S. EPA Tier 3, CARB Tier 3, EU Stage IIIA**

**Cummins Industrial Warranty** Coverage for two years or 2000 hours of operation, whichever occurs first, from the date of delivery of the power unit to the first user, or from the date the unit is first leased, rented or loaned, or when the power unit has been operated for 50 hours, whichever comes first. If the 2000 hour limit is exceeded during the first year, coverage continues until the end of the first year.

**J1939 Full-Authority Electronic Controls** Optimized engine performance. Provides seamless integration with other components. Includes advanced diagnostics and industry standard datalinks.

**Additional Front Crankshaft Pulley Groove & Aux. SAE "A" Drive** Provides greater versatility for accessory drive options. SAE A drive has 9, 10 & 11 tooth available.

**Noise Reduction & Smoother Running** Common Rail Fuel system provides for a quieter engine suitable in many environments.

**Cold Weather Starting Aid** Intake manifold heater grid, paired with common rail fuel system provides better cold weather starting and white smoke control.

**Fully Engineered Solution** Proper sizing and option selection ensures maximum performance.

## CUMMINS POWER PRODUCTS

### Available Features

---

Air Cleaner 25 g/cfm w / Safety Element & Restriction Indicator - Top or Rear mount

---

Twin Disc Clutch PTOs or Hayes Pump Housings  
Linear Throttle Control

---

Full Enclosure

---

Electrical Wiring 12 or 24 Volt

---

Heater Starting Aid (grid)

---

Instrument Panel Mount - Open or Loose

---

Instrument Panel - J1939 ;  
Key switch, run/idle switch, increment/decrement switch, 9-pin J1939 diagnostic port and isolated panel with enclosed lockable box. Includes CAN-Trak with oil pressure, water temp., voltmeter, and tachometer gauges.

---

Baserail Engine Sub-Base  
Isolated & Non-isolated

---

Packaging for Domestic & International Shipping

---

Cooling System - Includes; radiator, fan, shroud, deaeration tank, guarding, tubes. Fully tested for Limiting Ambient Temps. Pusher and Puller fans available

---

Radiator Guard  
Grill Type & Stone/Debris Type

---

Exhaust System  
Industrial Muffler or Spark Arrester - Meets U.S. Forestry Service (5100-1b)

---

**Note:** All power units MUST include a Decal (DE), Baserail (MM), Packaging (PP), Cooling (RA) & Restriction Indicator (RI) option.

# QSB3.3

## QSB3.3

## FR-30230

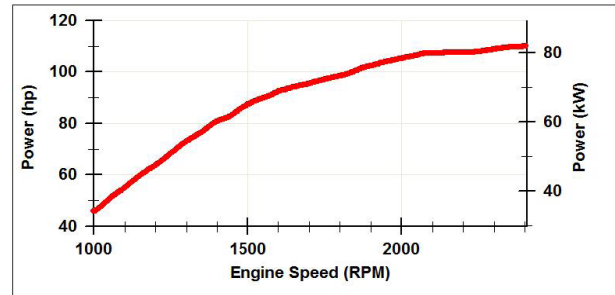
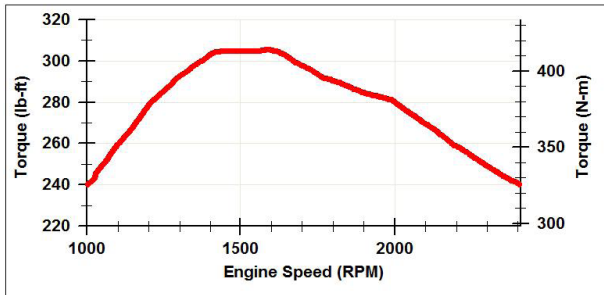

Curves shown above represent gross engine performance capabilities obtained and corrected in accordance with SAE J1995 conditions of 29.81 in Hg (100 kPa) barometric pressure [300ft (91m) altitude] 77 deg F (25 deg C) inlet air temperature, and 0.30 in Hg (1kPa) water vapor pressure with No. 2 diesel fuel.

All data is based on the engine operating with fuel system, water pump, and 15 in H<sub>2</sub>O (3.739 kPa) inlet air restriction with 3 in (76 mm) inner diameter, and with 3 in (76 mm) exhaust restriction with 3 in (76 mm) inner diameter; not included are alternator, fan, optional equipment and driven components.

The engine may be operated up to 7,546ft (2,300m) altitude before electronic derate is applied.

### Specifications

Advertised Horsepower	80-110 BHP	60-82 kW
Peak Torque	274-306 LB-FT	371-415 NM
Number of Cylinders	4	
Displacement	199 cu in.	3.3 Liters
Bore and Stroke	3.74 in x 4.53 in	95mm x 115mm
Aspiration	Turbocharged and Charge Air Cooled	
Oil System Capacity	7.4-11.6 U.S. Quarts	7.0-11.0 Liters
Power Unit Weight (Dry)	Open 1017 LBS	461 kg
	Enclosed 1121 LBS	508.5 kg
Total Cooling System Capacity	12.2 U.S. Quarts	11.5 Liters

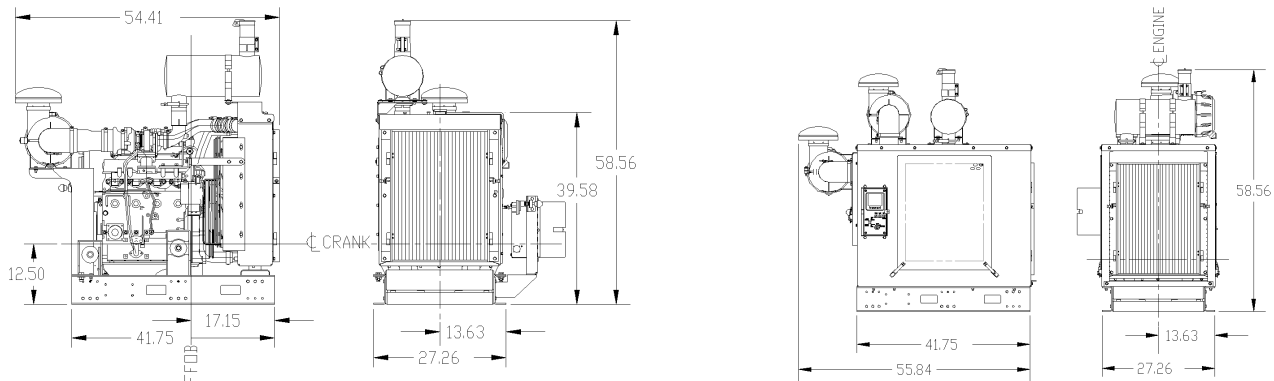

### Cummins Power Products

21810 Clessie Court  
 New Hudson, Michigan 48165  
 Phone: 248-573-1600  
 Fax: 248-573-4014  
 Internet: [cpp.cummins.com](http://cpp.cummins.com)